

**MILITARY**  
Standard Issue

PROUDLY MADE  
IN THE USA



330.308.6360  
330.365.9329 fax

[www.manta.us](http://www.manta.us)

326 Pearl Street N.E.  
New Philadelphia, OH 44663

## Vertical Grip Sleeve

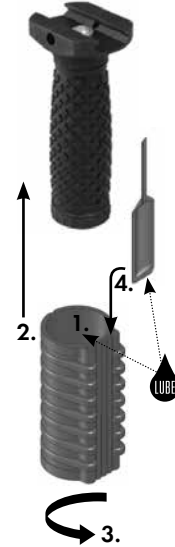

1. Lubricate the inside wall of the vertical grip sleeve with a generous amount of the supplied gel lubricant or hand sanitizer.
2. Slide the vertical grip sleeve onto and over the vertical grip.
3. Rotate the Micro-pocket on the vertical grip sleeve to the desired operating position.
4. Apply a small amount of lubricant or hand sanitizer to the leading edge of the pressure pad, and insert the pressure pad into the Micro-Pocket.



**i**  
Grip sleeves  
can be trimmed  
for a custom fit.

## Grip Pod Sleeve / Pistol Grip Sleeve

1. Lubricate the inside wall of the sleeve with a generous amount of the supplied gel lubricant or hand sanitizer and slide over the pistol grip or grip pod.
2. If installing the sleeve on a grip pod, unscrew bottom nut and remove the nut, legs and internal spring. Slide sleeve over the bottom flange and onto the grip pod.
3. Once the sleeve is installed, reassemble internal spring, legs and bottom nut.

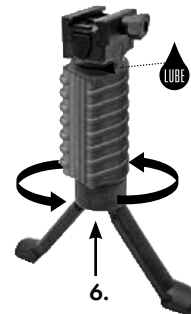

## Suppressor Sleeve

1. Apply a liberal amount of manta lube or hand sanitizer to the inside of the MSS sleeve.
2. Slide the recessed end of the MSS onto and over the suppressor and rotate the sleeve so that the solid (non vented) area is located at the 12 o'clock position in relation to the weapon.
4. Install the desired number of segments in a series, following step 2, so that the protruding end (front) will nest into the recessed end (rear) of the next sleeve. Seat each MSS segment completely into the next in order to avoid gaps between the segments.
5. When multiple segments are installed onto a suppressor in a series, visually confirm that the thin line (located on the outside of the sleeve over the 12 o'clock position) is aligned on each adjacent segment maintaining the 12 o'clock position down the length of the series of MSS segments.
6. Segments can be trimmed to any length for custom fit using scissors or razor edge tool.

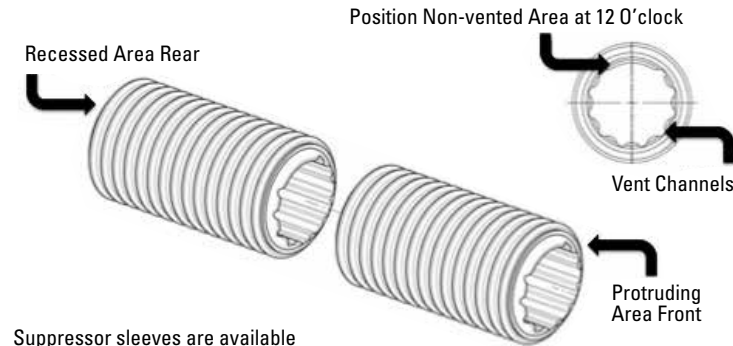

Suppressor sleeves are available in varying lengths and diameters.



**WARNING: Not recommended for use in excess of 100 rounds of cyclic or continued rapid fire.**



**Product Instructions**

## Rail Cover Panel & Wire Routing Panel

VERY LOW PROFILE  
RAIL COVER PANEL

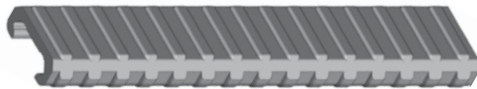

VERY LOW PROFILE  
CROSS CLIP WIRE  
ROUTING PANEL

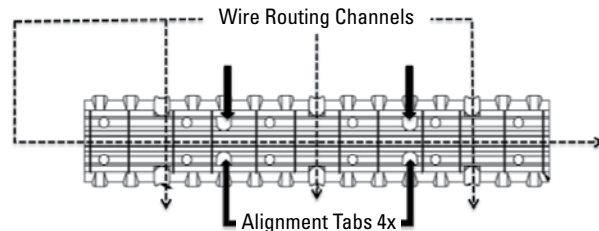
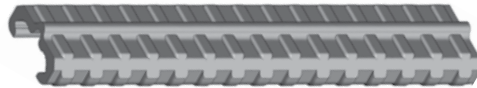

1. Align one side of the panel with the edge of your rail.
2. Visually check the underside of the panel and carefully line up the 4 alignment tabs with the slots on the rail.
3. Once the alignment tabs are in the desired position, snap the other edge of the panel down and over the opposite edge of the rail.

**TO INCREASE GRIP TENSION:**  
Squeeze the outside edges of the panel inward collapsing the inner metal clips. If overbending occurs, bend the sides of the panel back out to the desired position.



**NOTE:** Panels can be cut to length where internal clips are not located. Feel for the clips through the polymer surface and cut with a sharp object to the desired length.

## Micro-pocket Panel

1. Insert the pressure pad through the slit of the optional MANTA End Cap.
2. Insert the pressure pad into the MANTA Micro-pocket Panel and adjust to the desired position. If multiple MANTA panels are used in a series, insert the pressure pad and wire through all of the panels that are positioned in line before placing the series onto the rail.
3. Align one side of the panel with the edge of your rail.
4. Visually check the underside of the panel and carefully line up the two alignment tabs on the bottom with the slots on the rail.
5. Once the alignment tabs are in the desired slot, snap the other edge of the panel down and over the opposite edge of the rail.
6. Attach the second MANTA End Cap on the opposite end of the micro-pocket panel and push together until it rests flush against the panel. Push end caps inward to provide a secure fit and alignment.

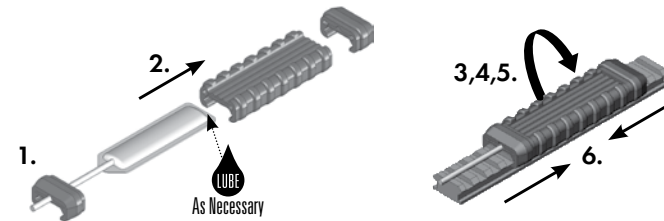

**TO INCREASE GRIP TENSION:**  
Squeeze the outside edges of the panel inward collapsing the inner metal clips. If overbending occurs, bend the sides of the panel back out to the desired position.



**NOTE:** If insertion of pressure pad(s) becomes difficult, apply a generous amount of our optional MANTA lubricant or hand sanitizer to the surface of the switch or wire to ease installation.

## Cross Clip & Wire Clip



MANTA  
WIRE CLIP

MANTA  
CROSS CLIP



1. Position wire under the clip in the desired routing direction.
2. Wire can be routed parallel or perpendicular to the barrel. Extra lengths of wire can be taken up by routing wire in and through the wire channels on the underside or two wire channels on the top. (See illustration examples.)
3. Holding the wire in place, align one side of the clip on the edge of the rail.
4. Visually check the underside of the clip and carefully line up the alignment tabs with the slots on the rail.
5. Once the alignment tabs are in the desired position, snap the other edge of the clip down and over the opposite edge of the rail.

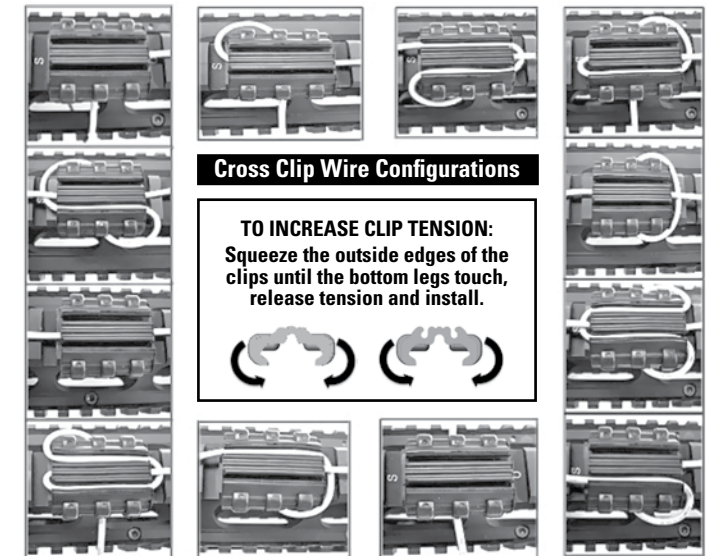

### Cross Clip Wire Configurations

**TO INCREASE CLIP TENSION:**  
Squeeze the outside edges of the clips until the bottom legs touch, release tension and install.

